

Quick-Connect

Newson Gale provides a universal system of connectors that provide quick and easy installation / replacement of 2 pole clamps and cables. **Quick-Connect** is supplied as standard for 2 pole clamps, cables, indicator stations and junction boxes across the **Earth-Rite** and **Bond-Rite** range.



2 pole clamp,
cable and junction box complete
with In-Line and Junction Box
Quick-Connectors



Hytrel cable supplied with male and
female In-Line Quick-Connects

- Universal system of interchangeable clamps and cables for the Earth-Rite and Bond-Rite range.
- Rapid and secure connection of parts.
- Straightforward installation and removal of clamps and cables for cleaning and refurbishment.
- Suitable for the harshest operating environments.
- IP67 with temperature range of -40°C to + 90°C.
- Flexible for stocking X90-IP and X45-IP clamps and 3m (10ft) 5m (16ft), 10m (32ft) and 15m (50ft) of Hytrel cable.



X90-IP with
In-line Quick-Connect



X45-IP with
In-line Quick-Connect



Quick-Connect

3 Easy Steps for Wiring



- Place connector components on cable in the order shown.
- Strip sheath to expose 5mm of copper conductors.
- Crimp both cores to provide secure connection.



- Insert earth core (BLACK) into designated earth terminal on connector.
- Insert IS core (RED) into terminal 1.
- Tighten screws to lock conductors in place.



- When the conductors are secure screw on the housing to cover the cores.
- Once secure screw on the gland cover to secure the cable to the connector.



Junction Box Quick-Connects for panel mounting in junction boxes and indicator stations (male & female).

Male In-Line Quick-Connect



Nut size 27

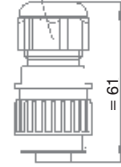

Female In-Line Quick-Connect

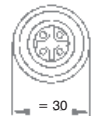

Nut size 27

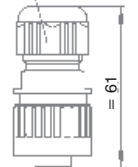

Junction Box Quick-Connect for panel mounting in Junction Boxes and Indicator Stations

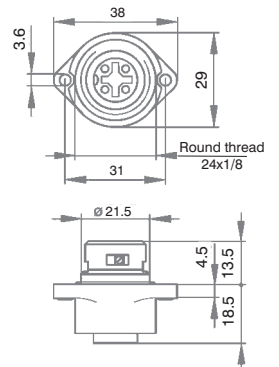

Technical Data

Pin dimensions	2 mm
Rated voltage	AC 400 V / DC 250 V
Rated current	DC 10 A / AC 16 A
Contact resistance	<= 3mOhm
Type of termination	screw
Description	Straight cable socket integrate strain relief
Number of contacts	3+PE
Cable gland	M 22x2
Cable diameter	6mm to 12mm
Conductor size	max. 2.5mm ²

Environmental Conditions

Protection class (IEC 60529)	IP 67
Pollution severity	3
Temperature range	-40°C to +90°C

Flammability Class

Flammability, UL standard	94 V-0
---------------------------	--------

Ordering Codes

Product Description

CAB2B10F	10m (32ft) of 2 Core Hytrel cable with female In-Line Q/C
CAB2B10Q	10m (32ft) of 2 Core Hytrel cable with In-Line male & female Q/Cs
IPX90/2B10	X90-IP clamp fitted with 10m (32ft) of 2 Core Hytrel cable with In-Line female Q/C
IPX45/2B10	X45-IP clamp fitted with 10m (32ft) of 2 Core Hytrel cable with In-Line female Q/C
IPX90/2B10Q	X90-IP clamp fitted with 10m (32ft) of 2 Core Hytrel cable with In-Line male & female Q/C
IPX45/2B10Q	X45-IP clamp fitted with 10m (32ft) of 2 Core Hytrel cable with In-Line male & female Q/C

For 3m (10ft), 5m (16ft) or 15m (50ft) lengths of cable replace '10' with the desired length in the product codes provided

The Quick-Connect forms part of the Earth-Rite and Bond-Rite range of Static Grounding and Bonding Equipment available from Newson Gale



Leading the way in hazardous area static control

www.newson-gale.com

Newson Gale Inc
460 Faraday Avenue
Unit B, Suite 1
Jackson, NJ 08527
USA

Tel: +1 732 987 7715
Fax: +1 732 791 2182

Email: groundit@newson-gale.com

Newson Gale Ltd
Omega House
Private Road 8
Colwick, Nottingham
NG4 2JX, UK

Tel: +44 (0)115 940 7500
Fax: +44 (0)115 940 7501

Email: groundit@newson-gale.co.uk