

Quick-Connect

Newson Gale provides a universal system of connectors that provide quick and easy installation / replacement of our 2-pole clamps and cables. **Quick-Connect** is supplied as standard for 2-pole clamps, cables, indicator stations and junction boxes across the **Earth-Rite** and **Bond-Rite** range.



2-pole clamp,
cable and junction box complete
with In-Line and Junction Box
Quick-Connectors



Hytrel cable supplied with male and
female In-Line Quick-Connects



- Universal system of interchangeable clamps and cables for the Earth-Rite and Bond-Rite range.
- Rapid and secure connection of parts.
- Straightforward installation and removal of clamps and cables for cleaning and refurbishment.
- Suitable for the harshest operating environments.
- IP67 with temperature range of -40°C to + 90°C.
- Flexible for stocking X90-IP and X45-IP clamps and 3m (10ft) 5m (16ft), 10m (32ft) and 15m (50ft) of Hytrel cable.



X90-IP with
In-line Quick-Connect



X45-IP with
In-line Quick-Connect

Newson Gale | For over 25 years Newson Gale has been supplying the chemical and processing industry worldwide with market leading range of static control products ensuring people and plant are protected from static related fires and explosions.



Quick-Connect

3 Easy Steps for Wiring



- Place connector components on cable in the order shown.
- Strip sheath to expose 5mm of copper conductors.
- Crimp both cores to provide secure connection.



- Insert earth core (BLACK) into designated earth terminal on connector.
- Insert IS core (RED) into terminal 1.
- Tighten screws to lock conductors in place.



- When the conductors are secure screw on the housing to cover the cores.
- Once secure screw on the gland cover to secure the cable to the connector.



Junction Box Quick-Connects
for panel mounting in junction boxes and indicator stations
(male & female).

Male In-Line Quick-Connect

Female In-Line Quick-Connect



Nut size 27

Nut size 27

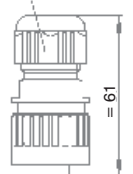
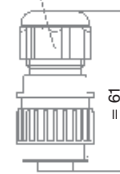

Junction Box Quick-Connect for panel mounting in Junction Boxes and Indicator Stations

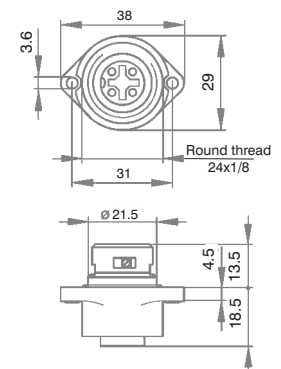

Technical Data	
Pin dimensions	2 mm
Rated voltage	AC 400 V / DC 250 V
Rated current	DC 10 A / AC 16 A
Contact resistance	<= 3mOhm
Type of termination	screw
Description	Straight cable socket integrate strain relief
Number of contacts	3+PE
Cable gland	M 22x2
Cable diameter	6mm to 12mm
Conductor size	max. 2.5mm ²

Environmental Conditions	
Protection class (IEC 60529)	IP 67
Pollution severity	3
Temperature range	-40°C to +90°C

Flammability Class	
Flammability, UL standard	94 V-0

Ordering Codes	Product Description
CAB2B10F	10m (32ft) of 2 Core Hytrel cable with female In-Line Q/C
CAB2B10Q	10m (32ft) of 2 Core Hytrel cable with In-Line male & female Q/Cs
IPX90/2B10	X90-IP clamp fitted with 10m (32ft) of 2 Core Hytrel cable with In-Line female Q/C
IPX45/2B10	X45-IP clamp fitted with 10m (32ft) of 2 Core Hytrel cable with In-Line female Q/C
IPX90/2B10Q	X90-IP clamp fitted with 10m (32ft) of 2 Core Hytrel cable with In-Line male & female Q/C
IPX45/2B10Q	X45-IP clamp fitted with 10m (32ft) of 2 Core Hytrel cable with In-Line male & female Q/C

For 3m (10ft), 5m (16ft) or 15m (50ft) lengths of cable replace '10' with the desired length in the product codes provided

The Quick-Connect forms part of the Earth-Rite and Bond-Rite range of Static Grounding and Bonding Equipment available from Newson Gale



Leading the way in hazardous area static control

www.newson-gale.com

Newson Gale Inc
460 Faraday Avenue
Unit B, Suite 1
Jackson, NJ 08527
USA

Tel: +1 732 987 7715

Fax: +1 732 791 2182

Email: groundit@newson-gale.com

Newson Gale Ltd
Omega House
Private Road 8
Colwick, Nottingham
NG4 2JX, UK

Tel: +44 (0)115 940 7500

Fax: +44 (0)115 940 7501

Email: groundit@newson-gale.co.uk